

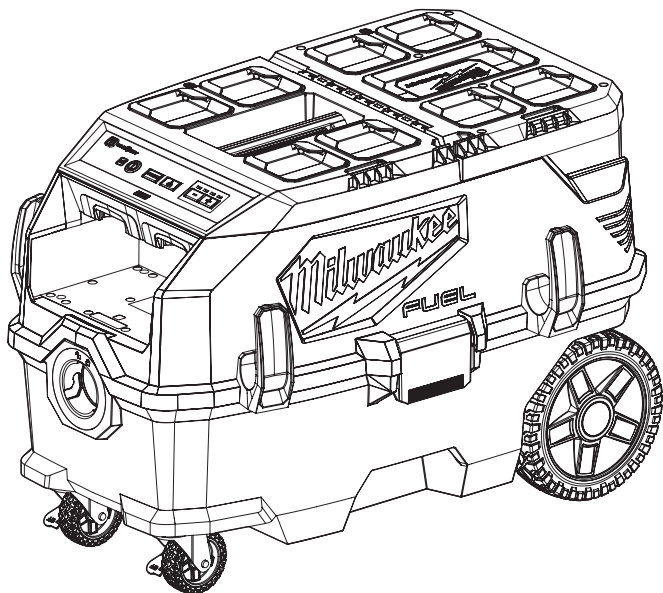

OPERATOR'S MANUAL



Cat. No.

**M18 ONEF2POVC34M**

**M18 FUEL™ PACKOUT™ DUAL BATTERY AC/DC 34L M-CLASS  
DUST EXTRACTOR WITH VACLINK™ AND ONE-KEY™**



 **WARNING**

 To reduce the risk of injury, user must read and understand operator's manual.

# IMPORTANT SAFETY INSTRUCTIONS

**WARNING** WHEN USING AN ELECTRICAL VACUUM, BASIC PRECAUTIONS SHOULD ALWAYS BE FOLLOWED, INCLUDING THE FOLLOWING: READ ALL INSTRUCTIONS BEFORE USING VACUUM. BEFORE USING THE VACUUM, READ THIS OPERATOR'S MANUAL, BATTERY PACK AND CHARGER OPERATOR'S MANUALS, AND ALL LABELS ON THE VACUUM, BATTERY PACK, AND CHARGER. FAILURE TO FOLLOW THE WARNINGS AND INSTRUCTIONS MAY RESULT IN ELECTRIC SHOCK, FIRE AND/OR SERIOUS INJURY.

**WARNING** TO REDUCE THE RISK OF FIRE, ELECTRIC SHOCK OR INJURY:

- This appliance is not intended for use by persons (including children) with reduced physical, sensory or mental capabilities, or lack of experience and knowledge, unless they have been given supervision or instruction concerning use of the appliance by a person responsible for their safety.
- Children should be supervised to ensure that they do not play with the appliance.
- Do not leave appliance when plugged in. Unplug from outlet when not in use and before servicing. Connect to a properly earthed outlet only.
- Do not expose to rain – store indoors.
- Use only as described in this manual. Use only manufacturer's recommended attachments.
- Do not use with damaged cord or plug. If appliance is not working as it should, has been dropped, damaged, left outdoors, or dropped into water, return it to a service centre.
- Do not pull or carry by cord, use cord as a handle, close a door on cord, or pull cord around sharp edges or corners. Do not run appliance over cord.
- Keep cord away from heated surfaces.
- Do not unplug by pulling on cord. To unplug grasp the plug not the cord.
- Do not handle battery packs, plug, or appliance with wet hands. Do not wrap cord around hand or fingers.
- Do not put any object into openings. Do not use with any opening blocked; keep free of dust, lint, hair, and anything else that may reduce air flow.
- Keep hair, loose clothing, fingers, and all parts of body away from openings and moving parts.
- Do not pick up anything that is burning or smoking such as cigarettes, matches, or hot ashes.
- Do not use without filters in place.
- Turn off all controls before plugging in or unplugging tool.
- Ensure all latches are secured before transporting. Do not transport with liquid in the tank.
- Use extra care when cleaning on stairs.
- Do not use tool as a step or ladder.
- Do not use to pick up flammable or combustible liquids such as petrol or use in areas where they may be present.
- Dust extractors have motors and other parts that can produce arcs or sparks during normal use. Do not use within 6 m of areas where explosive gases may be present (such as petrol pumps and places where liquids like paint thinners, cleaners, solvents, etc. are stored).

- Do not use as a water pump. Dust extractor is intended to vacuum water/air mixture.
- Unplug power cord whenever motor head is removed from tank.
- Do not use in the presence of explosive liquids or vapours.
- To reduce the risk of health hazards from other vapours or dust, do not vacuum carcinogenic, toxic or hazardous materials such as asbestos, arsenic, barium, beryllium, pesticides or other health endangered materials.
- Do not use where oxygen or anesthetics are used.
- Wear electrically insulated footwear, such as rubber boots, when vacuuming wet material.

**WARNING** To reduce the risk of injury, when working in dusty situations, wear appropriate respiratory protection or use a suitable dust extraction solution.

- Always use common sense and be cautious when using tools. It is not possible to anticipate every situation that could result in a dangerous outcome. Do not use this tool if you do not understand these operating instructions or you feel the work is beyond your capability; contact MILWAUKEE® Tool or a trained professional for additional information or training.
- Maintain labels and nameplates. These carry important information. If unreadable or missing, contact a MILWAUKEE® service facility for a replacement.

**WARNING** Some dust created by power sanding, sawing, grinding, drilling, and other construction activities contains chemicals known to cause cancer, birth defects or other reproductive harm. Some examples of these chemicals are:

- lead from lead-based paint
- crystalline silica from bricks and cement and other masonry products, and
- arsenic and chromium from chemically-treated lumber.

Your risk from these exposures varies, depending on how often you do this type of work. To reduce your exposure to these chemicals: work in a well ventilated area, and work with approved safety equipment, such as those dust masks that are specially designed to filter out microscopic particles.

• Before using the dust extractor, read this operator's manual, your tool's manual, and all labels on the dust extractor and tool. This tool is for commercial use.

READ AND SAVE ALL INSTRUCTIONS FOR FUTURE USE FOR COMMERCIAL USE ONLY.

## EXTENSION CORDS









### Guidelines for Using Extension Cords

- If you are using an extension cord outdoors, be sure it is acceptable for outdoor use.
- Be sure your extension cord is properly wired and in good electrical condition. Always replace a damaged extension cord or have it repaired by a qualified person before using it.
- Protect your extension cords from sharp objects, excessive heat and damp or wet areas.

## SPECIFICATIONS

Cat. No. ....	M18 ONEF2POVC34M
DC Input Volts.....	36 V DC
Battery Type.....	M18™
Charger Type.....	M18™
Recommended Ambient Operating Temperature.....	-18° to 40°C
AC Input Volts.....	230-240 V AC
AC Input Amps.....	6.2 A
AC Input Hertz.....	50 Hz
Input Watts (AC).....	1,440 W
Input Watts (DC).....	750 W
Tank Capacity.....	34 L
Wet Capacity.....	17 L
Hose Diameter.....	36 mm
Weight.....	20 kg
Max Air Flow (AC)	
At hose end.....	2,550 l/min
At motor.....	4,960 l/min
Max Air Flow (DC)	
At hose end.....	1,980 l/min
At motor.....	3,540 l/min
Max Vacuum (AC)	
At hose end.....	199 mbar
At motor.....	236 mbar
Max Vacuum (DC)	
At hose end.....	174 mbar
At motor.....	199 mbar
HEPA Filter Kit – 2 Pk.....	49901968
Fleece Bag – 5 Pk.....	49901969

## SYMBOLOLOGY

-  Volts
-  Direct Current
-  Read Operator's Manual
-  Wear eye protection.
-  Do not step.
-  ONE-KEY™
- VACLINK** Tool has VACLINK™ technology
-  Unlocked
-  Locked

 M-Class dust extraction



Regulatory Compliance Mark (RCM). This product meets applicable regulatory requirements.



Do not dispose of electric tools together with household waste material. Electric tools and electronic equipment that have reached the end of their life must be collected separately and returned to an environmentally compatible recycling facility.

## FUNCTIONAL DESCRIPTION

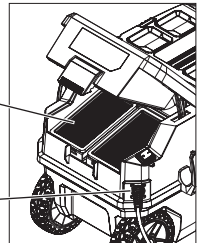
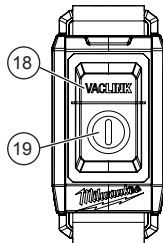
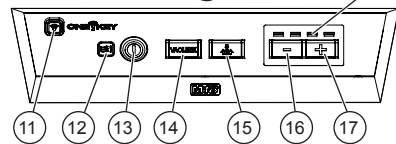
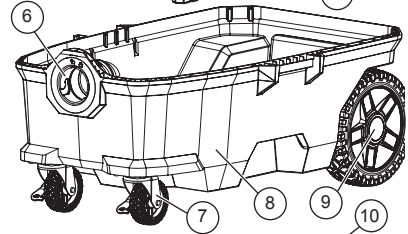
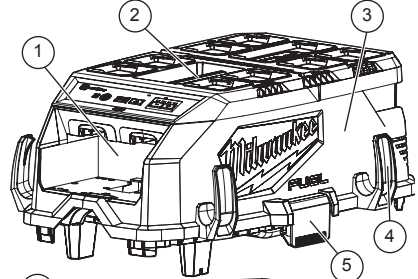

1. Batteries bay
2. Handle
3. Motor housing
4. Hose hook
5. Housing latch
6. Inlet fitting
7. Locking castors
8. Tank
9. Wheel
10. Air speed indicator
11. ONE-KEY™ indicator
12. Low airflow indicator
13. ON/OFF button
14. VACLINK™ pairing button
15. Filter cleaning button
16. Decrease air speed button
17. Increase air speed button
18. VACLINK™ pairing button
19. ON/OFF button
20. Filters
21. AC inlet

## ASSEMBLY

**⚠WARNING** Recharge only with the charger specified for the battery. For specific charging instructions, read the operator's manual supplied with your charger and battery.

### Inserting/Removing the Battery

To insert the battery, slide the pack into the body of the tool. Make sure it latches securely into place. **NOTE:** Two batteries are required for the product to operate on battery.

**⚠WARNING** Only use accessories specifically recommended for this tool. Others may be hazardous.

To remove the battery, push in the release buttons and pull the battery pack away from the tool.

**⚠WARNING** Always remove the battery packs and/or disconnect from AC power any time the tool is not in use.

Unpack accessories and parts from the tank by unlatching the motor housing and pulling it up and off the tank.

### VACLINK™

VACLINK™ is a wireless dust control technology that allows a compatible tool and vacuum/dust extractor to connect to each other.

A signal from the tool will turn the vacuum on and off. The tool can be connected to one dust extractor at a time. The dust extractor can be connected to multiple remotes or tools at time.

### Pairing a VACLINK™ Remote

If the VACLINK™ remote is not connected to the dust extractor, pairing can be setup by:

1. Insert battery packs into the dust extractor.
2. Press the VACLINK™ button on the dust extractor and the remote until both LED's begin to flash. A steady green light on both the dust extractor and the remote will confirm that the unit is paired.

**NOTE:** Remote needs to be within close proximity to ensure remote is receiving signal from the dust extractor. This procedure will time out after 30 seconds if the dust extractor is not paired and will enter standby mode for inactivity.

To confirm that the remote has paired with the dust extractor successfully, press the VACLINK™ button on remote and the VACLINK™ button on the dust extractor will light. Multiple remotes can be paired to one dust extractor.

To confirm that the remote has paired with the dust extractor successfully, press the VACLINK™ button on remote and the VACLINK™ button on the dust extractor will light. Multiple remotes can be paired to one dust extractor.

### Pairing a VACLINK™ Tool

Consult the VACLINK™ tool's manual for pairing to the dust extractor.

1. Install a battery pack on the tool and connect the dust extractor to a power source.
2. To pair, press and hold the pairing buttons on the tool and vac each for >1 second.

VACLINK™ LED:

- Searching – flashing green
- Paired – solid green

3. See the Troubleshooting table if tool and dust extractor do not pair successfully.

4. To unpair, press and hold the pairing button on the tool for >1 second.

VACLINK™ LED:

- Unpaired – off

### Unpairing VACLINK™ from all connected devices

1. To remove/erase all paired devices from dust extractor, press and hold the VACLINK™ button on the remote until the LED has a flashing red light.
2. Press and hold the VACLINK™ button on the dust extractor until the LED has a flashing red light.

If the remote and the dust extractor are not paired after 30 seconds, this procedure will time out and enter standby mode for user inactivity.

### Installing the Hose Hooks

1. Slide the four hose hooks onto the mounting brackets.
2. Wrap hose around head and on top of hose hooks for storage.

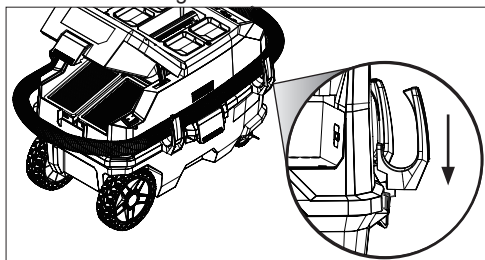

### Installing/Changing the Fleece Dust Bag

**⚠CAUTION** To avoid spilled debris when picking up heavy or sharp materials, monitor bag volume and do not overfill. For increased filter life and ease of cleanup, use a fleece dust bag to collect fine dust particles.

1. **⚠WARNING** Remove battery packs and/or disconnect from AC power to avoid starting the tool.
2. To install, release the housing latches and remove the motor housing.
3. Place the cardboard dust bag inlet around the tank inlet with the cardboard tab facing upwards.
4. Slide the cardboard dust bag inlet over the ridge of the tank inlet to secure.
5. Spread out the dust bag in the tank. Replace the motor housing and secure latches.
6. To remove, release the housing latches and remove motor housing.
7. Slide the dust bag away from the tank inlet and then up and out to remove from the tank.
8. Pull the cardboard tab until the dust bag inlet is closed. Dust bag is now sealed and can be disposed in accordance with local regulations.

Replace fleece dust bag once the bag is at full capacity, suction decreases or dust bag is damaged.

## Installing the Hose and Accessories

1. Fit the hose into the inlet and twist to secure.

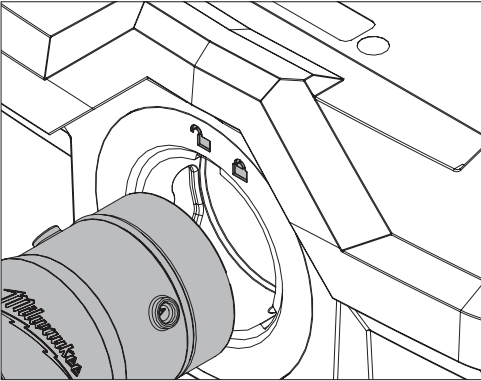

2. Press the button and insert the appropriate tool or accessory onto the hose until the latch clicks to secure.

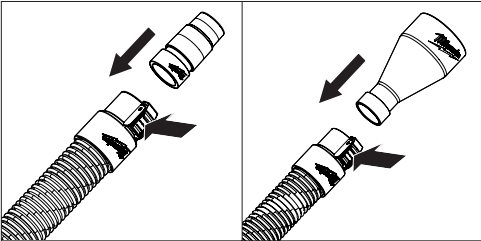

## Removing/Installing the Filters

Filters can become clogged during heavy use. To maintain the efficiency of the dust extractor, empty/change the filter bag and clean all of the filters periodically. **MILWAUKEE®** suggests cleaning/replacing the filters after 200 holes (at 16 mm diameter, 100 mm deep) or an equivalent amount of produced dust.

1. Turn **off** dust extractor.
2. **⚠WARNING** Unplug and remove batteries to avoid starting the tool.
3. Unlatch and open the filter compartment.

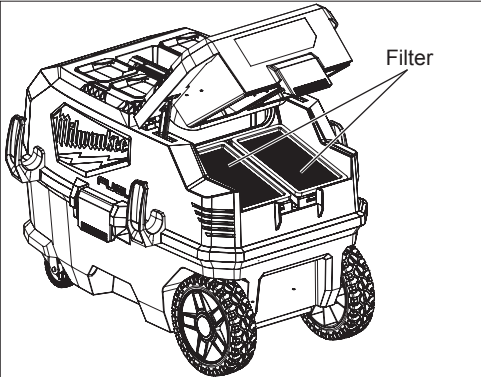

4. Pull the filters away from the extractor.
5. To clean the filter, use water and let filters dry completely before using with the extractor. Do not clean with compressed air.
6. Replace filters if damaged or airflow decreases. Discard the filter by carefully transferring it to a container with a tight-fitting lid. Disposal of filter needs to be done in accordance with local regulations. For replacement part number, see "Specifications".
7. To **install** the filters, reverse the procedure.

## ONE-KEY™

To learn more about the ONE-KEY™ functionality for this tool, go to [www.milwaukeeeetool.com.au/innovation/one-key/](http://www.milwaukeeeetool.com.au/innovation/one-key/). To download the ONE-KEY™ app, visit the App Store® or Google Play™ from your smart device.

### ONE-KEY™ Indicator

Solid Blue	Wireless mode is active and ready to be configured via the ONE-KEY™ app.
Blinking Blue	Tool is actively communicating with the ONE-KEY™ app.
Blinking Red	Tool is in security lockout and can be unlocked by the owner via the ONE-KEY™ app.

## OPERATION

**⚠WARNING** To reduce the risk of injury, always wear proper eye protection marked to comply with AS/NZS 1337.1. When working in dusty situations, wear appropriate respiratory protection or use a suitable dust extraction solution.

To reduce the risk of fire and injury, do not use to pick up flammable or combustible materials.

To reduce the risk of injury, wear safety goggles or glasses with side shields. Empty tank before use.

Before use, ensure the filter is properly installed.

### Selecting Air Speed

To increase or decrease the air flow speed, use the air speed control buttons. Press the - to decrease the air flow speed, and press the + to increase the airflow speed.

### Automatic Filter Cleaning

The dust extractor has an automatic filter cleaning system. For improved performance, it is recommended to turn on automatic filter cleaning when using the dust extractor. Press the filter cleaning button to turn on the filter cleaning function. The filter cleaning system will clean the filters about every 15 seconds during use.

### Manual Filter Cleaning

During extremely heavy or long uses, manual cleaning may be necessary.

To **manually** clean the filter:

1. Turn **on** dust extractor.
2. Turn **on** automatic filter cleaning.
3. Place the palm of your hand over the hose end for about 30 seconds.
4. Turn off the dust extractor.
5. If manual cleaning does not restore full suction, replace the filter.

## Low Airflow

The low airflow LED will light and an alert tone is played when an obstruction occurs and continues to play until obstruction is cleared or the dust extractor is turned off. The hose end features a variable air intake that can be adjusted by rotating collar as needed.

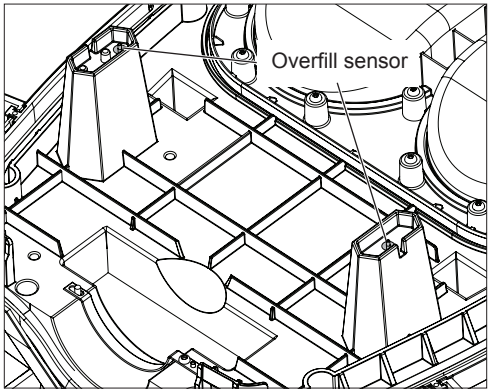
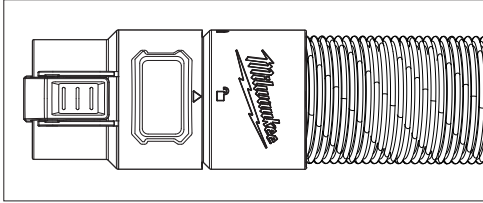

## Starting and Stopping Dust Extractor

To **start** the dust extractor, press the On/Off button on the tool, on a paired remote, or start a paired VACLINK™ tool.

To **stop** the dust extractor, press the On/Off button on the tool, on a paired remote, or stop a paired VACLINK™ tool.

**NOTE:** When the unit is connected via AC power, the AC power option will override the battery (even if batteries are inserted) and operate on AC power.

## Using VACLINK™

When using VACLINK™, one person must control both the dust extractor and the paired remote or tool. If the extractor becomes clogged, the operator must be able to turn the extractor off to prevent damage to the dust extractor.

- Once paired, set up the vacuum hose, work area, and job as needed, following the tool and dust extractor instructions.
- Turn on the tool. VACLINK™ will automatically turn on the dust extractor.
- Turn off the tool and the dust extractor will automatically turn off after a short delay.
- See Troubleshooting if tool and dust extractor do not operate as expected.

## Picking Up Dry Materials

Make sure that the tank is dry before using the dust extractor to pick up dry materials. If the extractor tank is wet, run the dust extractor for about 5 minutes (without picking up anything) to dry the inside of the tank.

Never pick up dry material without filters and fleece dust bag in place.

## Picking Up Wet Materials

**WARNING** To reduce the risk of electric shock, **DO NOT** pick up wet materials unless tank has been cleaned of dust and the dust bag has been removed. Turn off the extractor if foam or liquid escapes from the tool.

- WARNING** Remove battery packs and/or disconnect from AC power to avoid starting the tool.
- Release the housing latches and remove the motor housing.
- Remove dust bag and clean tank.
- On the underside of the motor housing, ensure the overfill sensors are dry and clean of debris. The overfill sensors shut off suction when the tank is full.

- Replace motor housing and latch in place.
- Insert battery packs and/or connect to AC power to power the dust extractor.
- Turn on the dust extractor.
- Suction wet materials.
- When finished, turn off the dust extractor.
- WARNING** Remove battery packs and/or disconnect from AC power to avoid starting the tool.
- Release the housing latches and remove the motor housing.
- To drain liquid, block wheels and carefully dump contents. Do not store dust extractor with liquid in tank.
- Rinse and dry tank. Run dust extractor for 5 minutes to ensure tank is thoroughly dry before picking up dry materials.

## Troubleshooting

Pairing is unsuccessful.	Remove battery packs or unplug the tool and power from vac for 1 minute. Retry the pairing procedure.
	Check the vacuum is in range of tool. Retry the pairing procedure.
	Move tool and vacuum to an area with lower wireless traffic. Retry the pairing procedure.
	If VACLINK™ is still unable to pair, contact authorised MILWAUKEE® service centre.
Vacuum not turning on/off automatically.	VACLINK™ is paused on the tool. Unpause VACLINK™.
	The vacuum is connected to a power supply. Connect vacuum to a power supply.
	The tool and vacuum are out of range of each other. Move vacuum and tool closer.
	Battery low. Replace battery in remote. Replace batteries on tool.
	If VACLINK™ still does not turn the vac on/off, unpair and re-pair the tool and vacuum.
	If VACLINK™ is still unable to pair, contact authorised MILWAUKEE® service centre.

## MAINTENANCE

**⚠WARNING** To reduce the risk of injury, always unplug the tool before performing any maintenance. Never disassemble the tool. Contact a MILWAUKEE® service facility for all other repairs.

### Maintaining the Filters

Filters can become clogged during heavy use. To maintain the efficiency of the dust extractor, empty the tank, change the filter bag, and clean both of the filters periodically. MILWAUKEE® suggests cleaning the filters after 200 holes (at 16 mm diameter, 100 mm deep) or an equivalent amount of produced dust.

### Maintaining Tool

Keep the tool, battery packs and charger in good repair by adopting a regular maintenance program. Inspect the tool for issues such as undue noise, misalignment or binding of moving parts, breakage of parts, or any other condition that may affect the tool operation. Return the tool, battery pack, and charger to a MILWAUKEE® service facility for repair. If the tool does not start or operate at full power with a fully charged battery pack, clean the contacts on the battery packs. If the tool still does not work properly, return the tool, charger and battery packs, to a MILWAUKEE® service facility for repairs.

### Internal Coin Cell Battery

**⚠WARNING** Chemical Burn Hazard. This device contains a lithium button/coin cell battery. A new or used battery can cause severe internal burns and



lead to death in as little as 2 hours if swallowed or enters the body. Always secure the battery cover. If it does not close securely, stop using the device, remove the batteries, and keep it away from children. If you think batteries may have been swallowed or entered the body, seek immediate medical attention.

An internal coin cell battery is used to facilitate full ONE-KEY™ and VACLINK™ Remote functionality. To replace the coin cell battery:

1. Remove the battery pack
2. Loosen the screw(s) and open the coin cell battery door.
3. Remove the old coin cell battery, keep it away from children, and dispose of it properly.
4. Insert the new coin cell battery (3V CR2032), with the positive side facing up.
5. Close the battery door and tighten the screw(s) securely.

**⚠WARNING** To reduce the risk of personal injury, electric shock and damage, never immerse your tool in liquid or allow a liquid to flow inside it.

### Cleaning

Clean dust and debris from vents. Keep handles clean, dry and free of oil or grease. Use only mild soap and a damp cloth to clean, since certain cleaning agents and solvents are harmful to plastics and other insulated parts. Some of these include petrol, turpentine, lacquer thinner, paint thinner, chlorinated cleaning solvents, ammonia and household detergents containing ammonia. Never use flammable or combustible solvents around tools.

### Storage

Before storing the dust extractor, always empty and clean the tank. Never allow debris to sit in the tank for any extended period of time. The dust extractor should be stored indoors.

### Repairs

For repairs, return the tool, battery pack and charger to the nearest authorised service centre.

## ACCESSORIES

**⚠WARNING** Use only recommended accessories. Others may be hazardous.

For a complete listing of accessories, go online to [milwaukeeetool.com.au](http://milwaukeeetool.com.au) / [milwaukeeetool.co.nz](http://milwaukeeetool.co.nz) or contact a distributor.

## **WARRANTY - AUSTRALIA and NEW ZEALAND**

Please refer to Australian and New Zealand warranty supplied with tool. This warranty applies only to product sold by authorised dealers in Australia and New Zealand.

## **SERVICE - AUSTRALIA and NEW ZEALAND**

**MILWAUKEE®** prides itself in producing a premium quality product that is Nothing But Heavy Duty™. Your satisfaction with our products is very important to us! If you encounter any problems with the operation of this tool, please contact your authorised **MILWAUKEE®** dealer.

For a list of **MILWAUKEE®** dealers, guarantee or service agents please contact **MILWAUKEE®** Customer Service or visit our website.

(Australia Toll Free Telephone Number 1300 645 928)

(New Zealand Toll Free Telephone Number 0800 645 928)

or visit [milwaukeetool.com.au/milwaukeetool.co.nz](http://milwaukeetool.com.au/milwaukeetool.co.nz).

### **Milwaukee Electric Tool Corporation**

13135 West Lisbon Road, Brookfield, Wisconsin U.S.A. 53005

#### **Milwaukee Tool (Australia)**

26 - 40 Nina Link, Dandenong South,  
Victoria, 3175, Australia

#### **Milwaukee Tool (New Zealand)**

274 Church Street, Penrose,  
Auckland, 1061, New Zealand

DESIGNED BY MILWAUKEE ELECTRIC TOOL CORP.